



PULL & TURN - System

1mm
DETACHABLE 568 568

Instruction Manual for Detachable Punches.

Squeeze handles
pull + turn clip

WEINMANN GmbH
Chirurgische Instrumente
Lupfenstraße 3
D 78606 Seitingen-Oberflacht

Tel. +49.7464.1584
Fax +49.7464.3234
info@weinmann-gmbh.de
www.weinmann-gmbh.de



Pull & Turn - System



- Squeeze the handles together.



- Pull the locking bar in the shown direction.

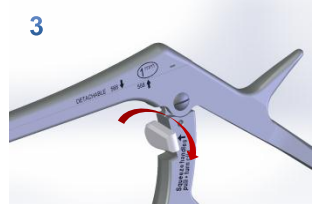

- Turn the locking bar in a horizontal position (90°) either clockwise or counter clockwise.

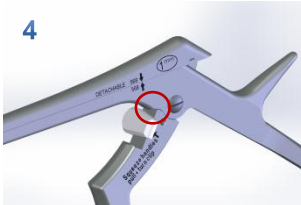

- Make sure the movable handle is on the limit stop shown.

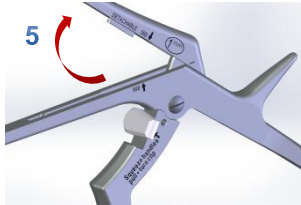

- In order to disassemble the instrument the marked arrows have to align each other.
- Pull the slider up.

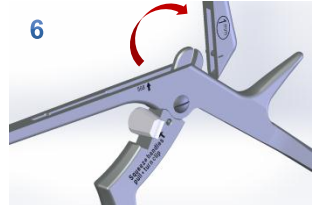

- When you rotate the slider around the backside of the main body (see figure), it can be taken apart.
- In this case you will notice a little resistance or "click".

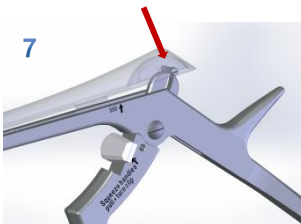

- For assembly make sure that the movable handle is on the limit stop as shown.
- Set the slider in the guidance and clip its bolt in the opened slot as shown.

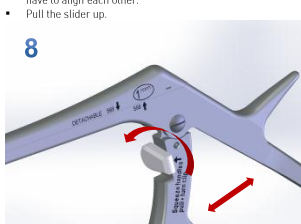

- Squeeze the handles together.
- Turn the locking bar in the vertical position (0°).
- You will notice a little motion caused by a spring back to the original state.

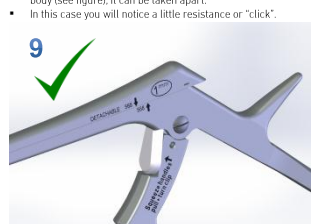

- Now the instrument is ready to use again.